

TYP = TYPICAL  
 FHWA = FEDERAL HIGHWAY  
 ADMINISTRATION

10' OR 5' (SEE NOTE 7) WITH 2"x8" S

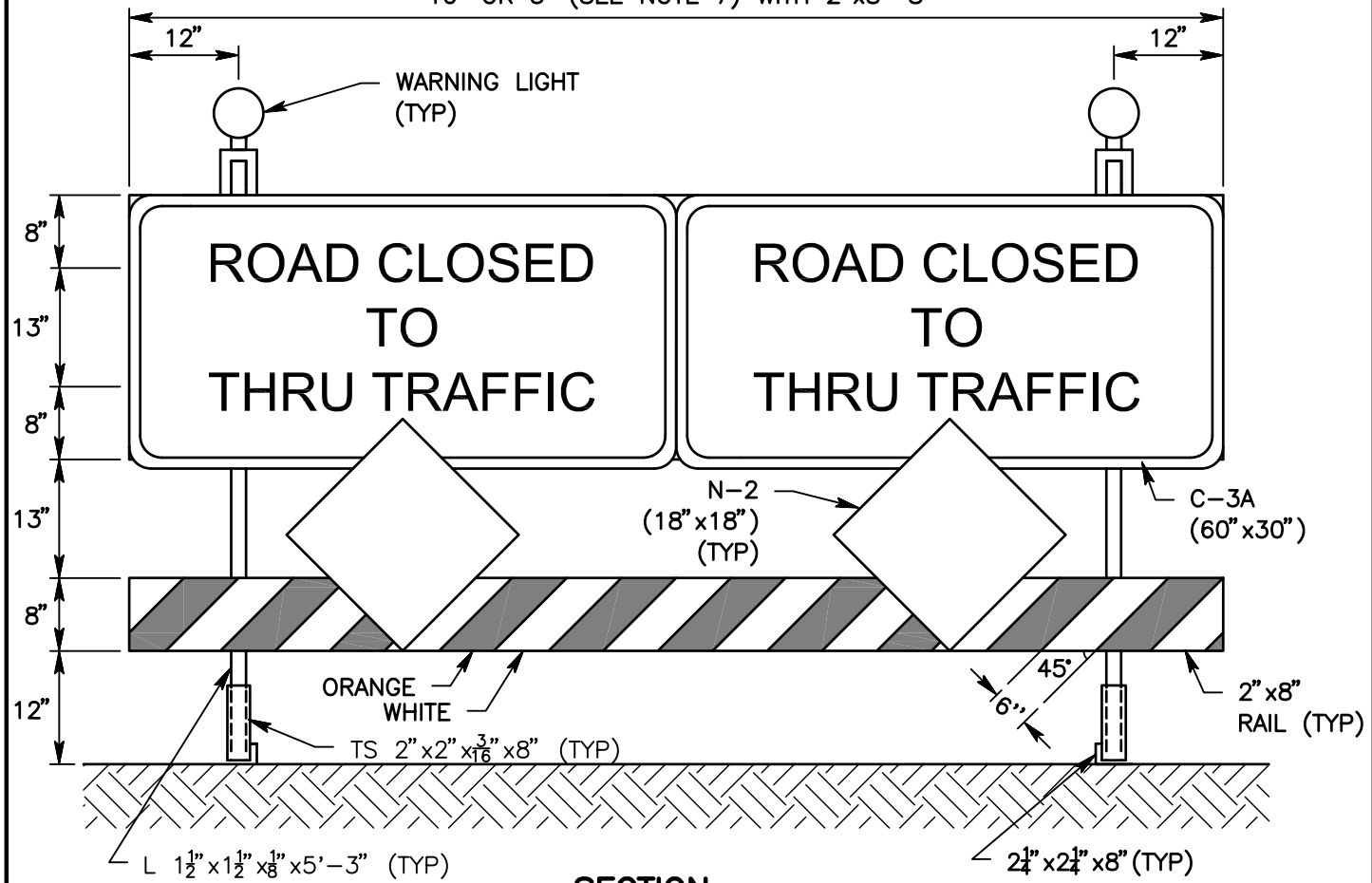

**SECTION**

NOTES:

1. ALL TIMBER SHALL BE S4S.
2. WHITE AND ORANGE PAINTED STRIPES SHALL BE REFLECTORIZED PER FHWA II (ENGINEERING GRADE SHEETING).
3. TRAFFIC CONTROL DEVICES SHALL BE OF HIGH INTENSITY SHEETING.
4. FOR RAIL TO POST CONNECTION, PROVIDE 2 3/8" CARRIAGE BOLTS WITH CUT WASHERS AND NUTS.
5. ADVANCE CONSTRUCTION SIGNS ARE REQUIRED.
6. USE N-2 VISUAL IMPACT PERFORMANCE (VIP) SHEETING.
7. FOR 5' BARRICADE, USE ONLY ONE C-3A AND N-2 MOUNTED AT THE CENTER OF THE ASSEMBLY.

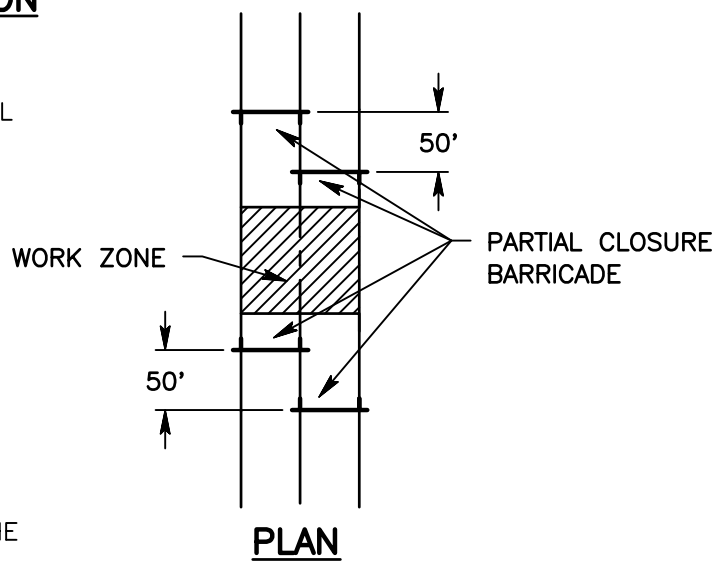

**PLAN**



**SAN BERNARDINO COUNTY DEPARTMENT OF PUBLIC WORKS**

**PARTIAL ROAD CLOSURE BARRICADE**

BRENDON P. BIGGS, PE  
 DIRECTOR OF PUBLIC  
 WORKS/ROAD  
 COMMISSIONER

**305F**